

PCP

AIR RIFLES

Puncher S.Jumbo

Puncher Jumbo Dazzle

Puncher Np-500

Puncher Pro-500

Puncher Bighorn

Puncher Np-02

Puncher Bigmax X

Puncher Shadow

Puncher Super Duty



KRAL ARMS



KRAL ARMS

INDEX

Welcome - About Your Airgun.....	2
Warning.....	3-4
General Parts Explanation.....	5-7
Demond and General Information.....	8-10
Dissamble The Barrel.....	11
Filling The Magazine.....	12
Mechanism Parts and Part Numbers.....	13-19
Super Jumbo.....	13
Jumbo Dazzle.....	15
Np 500.....	17
Bighorn.....	19
Bigmax X.....	21
PRO 500.....	23
Shadow.....	25
Np-02.....	27
Super Duty.....	29
Warranty Certificate.....	31



KRAL ARMS WELCOME

We would like you to know how happy we are to see you in this huge family as a user of puncher. Now you will be able to benefit from the services that the members of this family have benefited for many years and also you will be able to use your airgun confidently and peacefully for many years by paying attention to the instructions and taking into consideration this handbook as an integrated part of your airgun.

Using and maintaining your airgun as per the information included in this handbook will help you use your airgun hassle-free and safely. Even if the warranty expires, you can share the problems in your airgun with us or give your feedback to us while you join us in festivals that are organized each year all to your distributors. Since we know Your airgun the best after you and we want to take care of it. We would like to remind you that our after-sales team is waiting for you in order to answer your questions and assist you.

ABOUT YOUR AIRGUN

All of the components of your airgun have been designed and tested to meet all of the international standards by fully automatic CNC machines using Turkish and Italian steels at the highest quality standards of Kral Arms.

Note : This user manual has been prepared to cover all puncher models. You may find remarks and specifications that do not belong to your airgun.

The information and details in this handbook are valid for the period during which this was printed and 'Kral Silah San.' reserves the right to change or cancel the details related to any model without any obligation or warning.

Hope you enjoy your experience
Kral Arms



KRAL ARMS WARNING!



CAUTION !

THIS IS NOT A TOY. ONLY PERSONS OF AT LEAST 18 YEARS OLD WITH MENTAL AND PHYSICAL CAPABILITY CAN USE IT



CAUTION !

IN CASE OF SURFACE PARALLEL OR SKY SHOOTS, YOU MAY CAUSE DAMAGE TO 1000 yards (1km) AROUND YOU WITH THE EFFECT OF THE ACCELERATION OR FREE FALL EFFECT.



CAUTION !

YOUR AIRGUN'S SAFETY SHOULD ALWAYS BE ON (SAFETY ACTIVE) AND YOU SHOULD TURN OFF THE SAFETY ONLY RIGHT BEFORE THE IDEAL SOURCE LINE TO THE TARGET. (SAFETY PASSIVE)



CAUTION !

CHARGE WITH THE AIR THAT YOU ARE SURE TO HAVE BEEN DRIED WITH ELECTRICAL OR GRANULE TYPE DRYER. IN CASE OF FILLING WITH ORIGINAL KRAL PUNCHER HAND PUMP AVOID RAPID MOVEMENTS. OTHERWISE, LOWER SIDE OF THE PUMP MAY GO OUT OF THE IDEAL WORKING TEMPERATURE AND SWEAT WHICH WILL CAUSE HUMID CHARGING OF YOUR AIR TUBE.



CAUTION !

DO NOT FORCE YOUR AIR TANK TO OPEN (DEMOUNT). DO NOT USE ANY TANK THAT HAS BEEN TAMPERED DUE TO FALLING OR VARIOUS REASONS.



CAUTION !

OBEY THE LAWS, REGULATIONS AND RULES THAT ARE IN PLACE IN THE RELEVANT COUNTRY, PROVINCE, DISTRICT OR HUNTING GROUND WHETHER PRIVATE OR PUBLIC.



KRAL ARMS WARNING!

Always Remember The Following Precautions

- Try not to go shooting alone.
- Never use the airgun if you are intoxicated or under the influence of drugs.
- There is high pressure air inside your shotgun that is charged with the logic of squeezing
- Even if there is no pressure sign on the manometer, never disassemble the pressurized tube!
- Bring the safety on before interrupting your shotgun in any way and never point the barrel to yourself under any circumstance
- Only use cotton dry cloth to clean any dirt inside the barrel for various reasons (humidity, dust, etc.)
- You may observe that the groupment performance of the shotgun has reduced if you interrupt your shotgun due to dirt barrel outside the instructions given by the manufacturer (hard objects, cleaning with gear type mineral and synthetic oils, etc.) and cause your shot to go out of the warranty.
- In your shotgun, some of the parts work with larger tolerances while others are narrower. For this reason, use only synthetic or mineral base oil with high viscosity not creating filling effect.
- Your shotgun has been designed not to cause any sliding effect with corrosion.
- Various acids and bleaches inside the anti-corrosive oils might damage the tightness equipment and some of the covered surfaces.
- Calculate the areas where pellet might reach in each of your shoot on or off the target. This is extremely important for the safety of yourself and also living and non-living objects around you.
- Do not run or jump with a loaded shotgun. Your barrel should always point a safe distance while jumping through the ditches



- Always keep your shotgun at safety
- In case of long storage of your shotgun, always keep your shotgun dry-fired. (The spring type equipment that are always kept tight might undergo tightening or reduction in case of long storage)
- We do not recommend disassembling and reassembling the shotgun unless necessary. Do not disassemble or replace the original parts of your shotgun under any circumstance. Please contact the factory, general distributor or the authorized services of Kral Arms throughout Turkey.
- We especially recommend you to act as if your shotgun is always loaded. Even if you are in an empty land or forest, make sure that safety is on and your barrel points a safe direction. The owner of the shotgun shall be responsible for any damage.

**THIS REMINDER HAS BEEN WRITTEN TO KEEP YOU AWAY FROM MISTAKES
THAT MIGHT CAUSE INJURIES AND EVEN DEATH.**



CAUTION !

DANGER OF EXPLOSION!

THE AIR TANK POSES THE **EXPLOSION RISK** IF IT GETS HEATED
SUBJECT TO SUNTRAY FOR EXTENDED PERIOD OF TIME.
(Max. + 40° / Min. -05°)

OTHERWISE, THE AIRGUN SHOULD BE
LEFT TO COOL DOWN IN A COOL ENVIRONMENT
RECOMMENDED TO BE TRANSPORTED UNDER MAXIMUM 80 BARS
PRESSURE DURING FLIGHTS.



KRAL ARMS GENERAL PARTS EXPLANATION

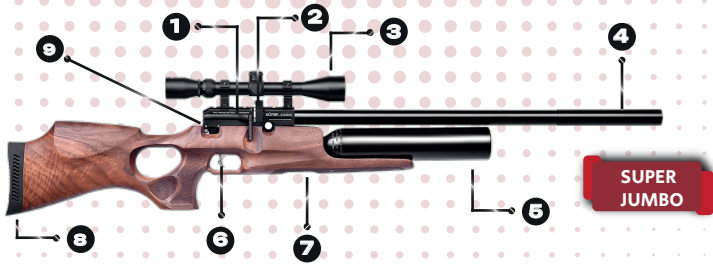
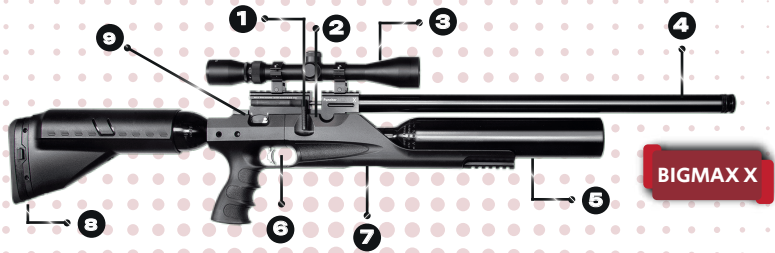
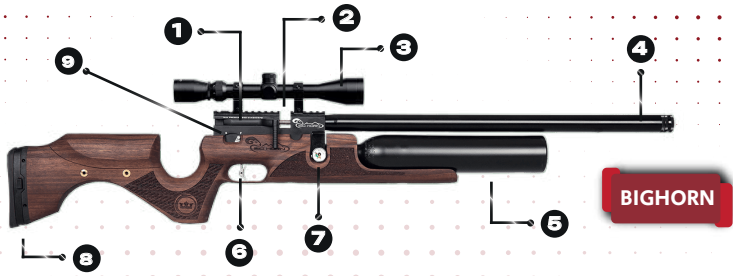

1 Cocking lever

2 Magazine

3 Scope

4 Shrouded barrel

5 Air Tank

6 Adjustable trigger

7 Manometer

8 Butt-pad

9 Manual safety



KRAL ARMS GENERAL PARTS EXPLANATION

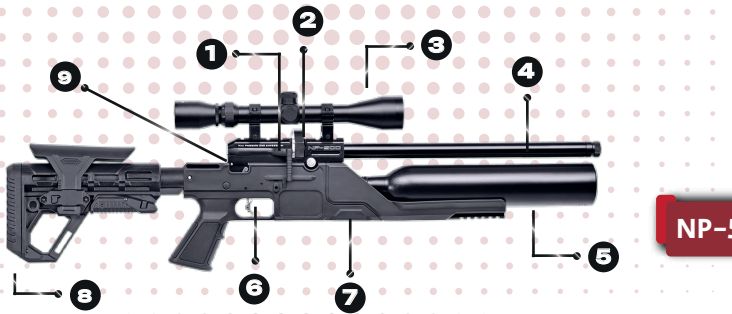
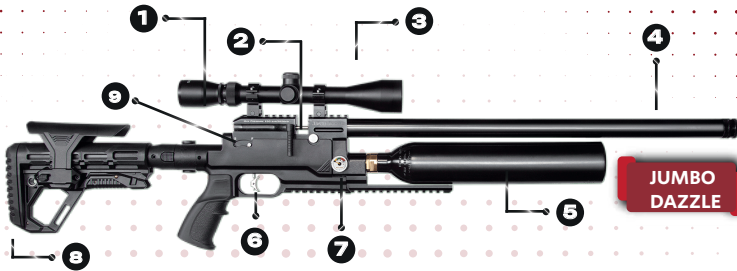

1 Cocking lever

2 Magazine

3 Scope

4 Shrouded barrel

5 Air Tank

6 Adjustable trigger

7 Manometer

8 Butt-pad

9 Manual safety



KRAL ARMS GENERAL PARTS EXPLANATION

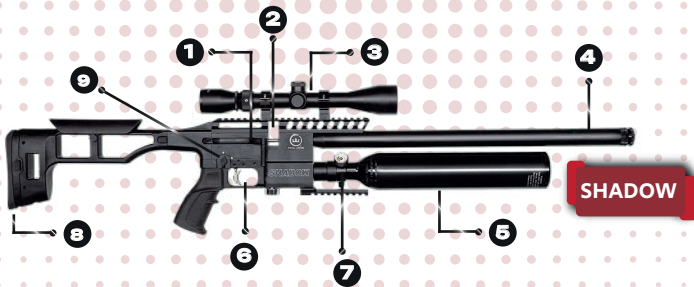
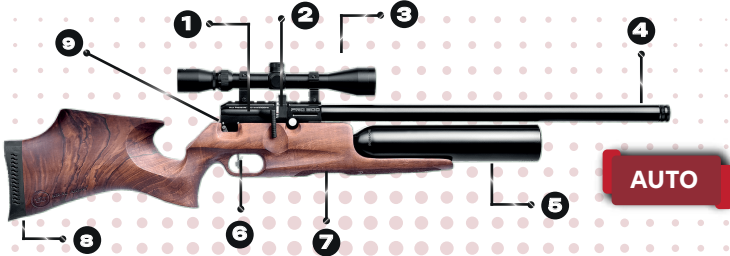
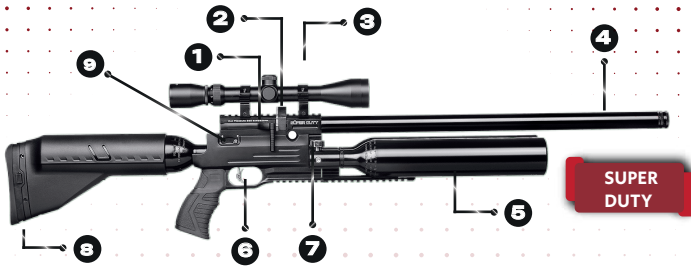

1 Cocking lever

2 Magazine

3 Scope

4 Shrouded barrel

5 Air Tank

6 Adjustable trigger

7 Manometer

8 Butt-pad

9 Manual safety



KRAL ARMS

DEMOND AND GENERAL INFORMATION



SEPARATING THE BODY

The carbine stock (monoblock) side of your shotgun has been balanced from center of gravity, positioned not to be subject to pressure or impact and dixed with a single allen head screw.You can remove easily with the help of 4 allen.

TRIGGER ADJUSTMENT

You can adjust the trigger movement distance without disassembling the shotgun but only through the bellow of the trigger guardrail(see picture 1) and adjust the hammer falling through inner trigger set screw

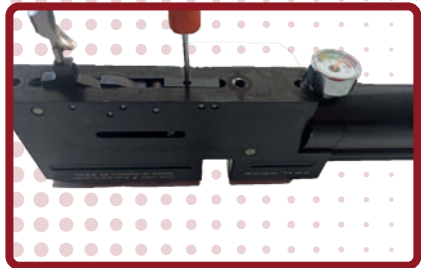

SAFETY

Safety "F" position means ready to fire (safety closed see picture)
Safety "S" position means unable ready to fire (safety open see picture)





KRAL ARMS

DEMOND AND GENERAL INFORMATION



MAGAZINE PLACEMENT

The new generation mechanic magazine can be attached and removed from the right side. The magazine that has run out of pellet will not permit new charge.

MANOMETER

Manometer might vary based on the puncher models. (air tank vertical to the front or body side).



POWER ADJUSTMENT

Barrel tightness o rings are three totally and 2 of them are outside while 1 is inside. In case of deformation, please replace with the spare o ring that are available inside the packaging.



KRAL ARMS

DEMOND AND GENERAL INFORMATION

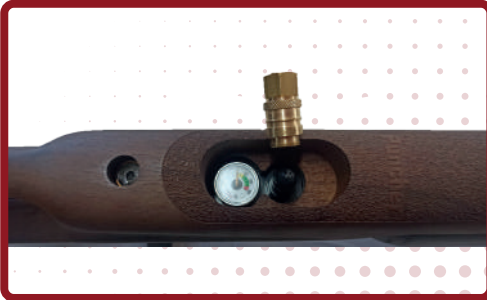

FILLING THE AIR TANK

The filling outlet is located at the tip of the air tube. Assemble the hose with the filling jack that is provided free of charge inside the box as a standard. If you hear sound of air during the first filling, move the jack and enable the orings to be air-proof. (if the leakage continues, o rings might be deformed)

SINGLE SHOT ASSISTANT

Single shot kit is a part that can be attached and removed only from the right side. 4.5mm (0.177) can be used with different sizes of kit while 5.5mm (0.22) and 6.35mm (0.25) can use the same kit.





KRAL ARMS

DISSAMBLE THE BARREL

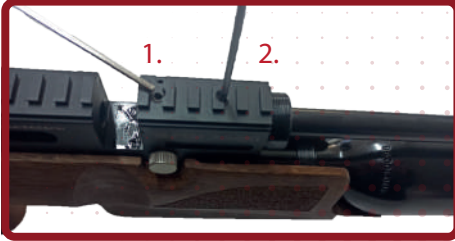

Dissamble the assemble screw of the receiver.(screw1)

Dissamble the assemble screw of the receiver(screw2).

Remove the barrel slowly.



Barrel tightness o rings are three totally and 2 of them are outside (②) (③) , while 1 inside. (①) . In case of deformation , please replace with the spare o.rings that are available inside the packaging.



KRAL ARMS

FILLING THE MAGAZINE

Rotate the idle front cover in the direction of the arrow (clockwise).

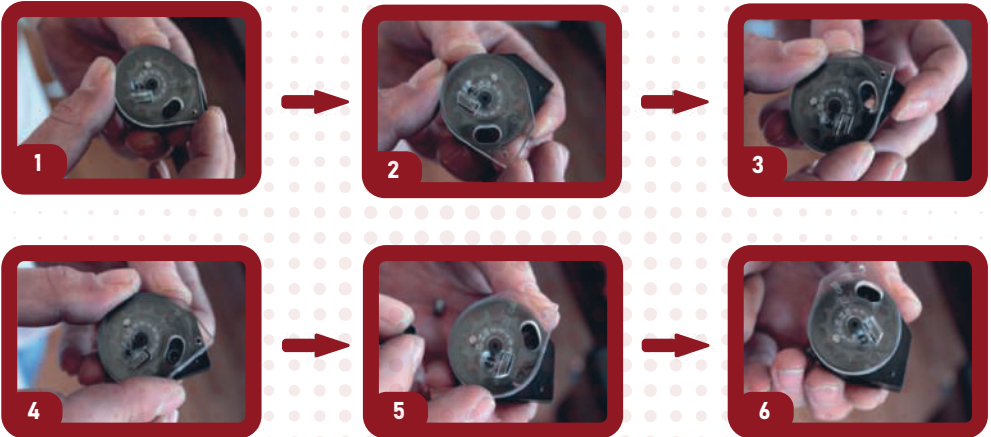

Once the glass cover hits are last point, prevent the pushing force of the spring and switch the Pellet to first bed(see picture 4).Once the first pellet prevents the rotation of the inner turret, move the glass cover on the contrary direction and fill the turret.

Note: It will prevent the assembly of turret system, do not force.
To watch the video, please visit www.kralarms.com



KRAL ARMS

MECHANISM PARTS AND PART NUMBERS

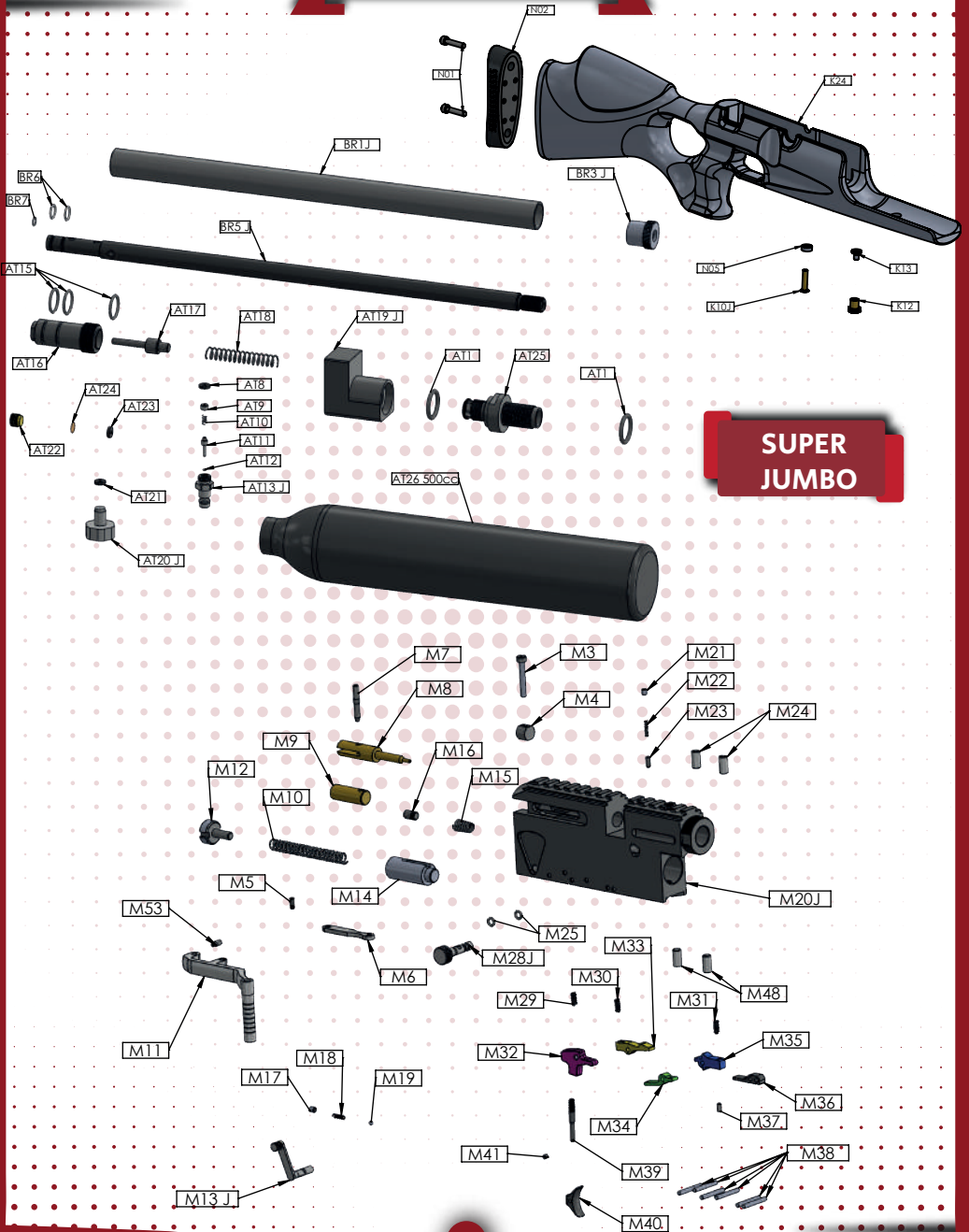

**SUPER
JUMBO**



KRAL ARMS

MECHANISM PARTS AND
PART NUMBERS

SUPER JUMBO

N01	Butt Pad Screw	M30	Inner Hammer Spring
N02	Butt Pad	M31	Locking Spring
N05	Receiver Fixing Pully	M32	Trigger
K10 J	Stock fixing Screw	M33	Inner Hammer
K12	Picatinny Assemble Nut	M34	Loading Part
K13	Picatinny Assemble Screw	M35	Inner Hammer Holder
K24	Super Jumbo Stock	M36	Hammer Holder Cover
M3	Cocking Lever fixing Screw	M37	Hammer Holder Adjustable Set-Screw
M4	Cocking Lever Fixing Nut	M38	Trigger Group Fixing Pin
M5	Cocking Lever Combination Screw	M39	Trigger Wire
M6	Cocking Lever Connection Part	M40	Trigger
M7	Connecting Pin	M41	Trigger Set-Screw
M8	Needle	M48	Valve Block Fixing Set-Screw
M9	Needle Connection Part	M53	Hammer to Receiver Screw
M10	Hammer Spring	BR1J	Barrel Shroud
M11	Cocking Lever	BR3J	Shroud Centering Part
M12	Hammer setting screw	BR5J	Barrel
M13J	Safety	BR6	Barrel Outer O-ring
M14	Hammer	BR7	Barrel Inner O-ring
M15	Needle Spring	AT1	Tube Front Valve Block O-ring
M16	Needle Spring Set-Screw	AT8	Filling Port Lower O-Ring
M17	Safety Set-Screw	AT9	Filling Port Set-Screw
M18	Safety Spring	AT10	Filling Port Spring
M19	Safety ball	AT11	Filling Port Valve
M20J	Receiver	AT12	Filling Port Valve O-Ring
M21	Adjustable Power Set-Screw	AT13J	Filling Port
M22	Adjustable Power Spring	AT15	Valve Block O-rings
M23	Adjustable Power Pin	AT16	Valve Block
M24	Barrel fixing Set-Screw	AT17	Long Valve
M25	Adjustable Power O-Ring	AT18	Long Valve Spring
M26	Adjustable Power Ball	AT19J	Valve Block
M27	Adjustable Power Spring	AT20J	Manometer
M28J	Adjustable Power Button	AT21	Manometer Lower O-Ring
M29	Trigger Spring	AT26	500 cc Air Tube



KRAL ARMS

MECHANISM PARTS AND PART NUMBERS

JUMBO DAZZLE





KRAL ARMS

MECHANISM PARTS AND
PART NUMBERS

JUMBO DAZZLE

TK1	Butt Pad	M20D	Receiver
TK2	Butt Pad Fixing Part	M21	Adjustable Power Set-Screw
TK3	Butt Pad Log Pin	M22	Adjustable Power Spring
TK4	Tactical Stock	M23	Adjustable Power Pin
TK5	Tactical Fixing Tube	M24	Barrel Fixing Set-Screw
TK6	Cheek Piece	M25	Adjustable Power O-Ring
TK7	Cheek Piece Button	M26	Adjustable Power Ball
TK8	Cheek Piece Log Pin	M27	Adjustable Power Spring
TK9	Cheek Piece Button Spring	M28D	Adjustable Power Button
TK10	Cheek Piece Stock Right	M29	Trigger Spring
TK11	Cheek Piece Stock Left	M30	Inner Hammer Spring
TK12	Cheek Piece Stock Nuts	M31	Locking Spring
TK13	Tactical Folding Pin	M32	Trigger
TK14	Tactical Butt Pin	M33	Inner Hammer
TK15	Tactical Folding Pin Spring	M34	Loading Part
TK16	Folding Stock	M35	Inner Hammer Holder
TK17	Folding Stock Connecting Pin	M36	Hammer Holder Cover
TK18	Button Spring	M37	Hammer Holder Adjustable Set-Screw
TK19	Block Fixing Stock	M38	Trigger Group Fixing Pin
TK20	Button	M39	Trigger Wire
TK21	Lock Pin	M40	Trigger
TK22	Lock Fixing Pin	M41	Trigger Set-Screw
TK23	To and Fro Button Pin	M48	Valve Block Fixing Set-Screw
TK24	To and Fro Button Spring	M53	Hammer to Receiver Screw
TK25	To and Fro Button Button	BR1D	Barrel Shroud
TK26	Tactical and Folding Fixing Pin	BR2	Shroud Centering O-Ring
K17	Dazzle Stock	BR3	Shroud Centering Part
TK26	Tactical and Folding Fixing Pin	BR4	Shroud Centering Nut
TK27	Tactical Stock Fixing Screw	BR5D	Barrel
M45	Grip Screw	BR6	Barrel Outer O-ring
M46	Grip	BR7	Barrel Inner O-ring
M47	Grip Cover	AT1	Tube Front Valve Block O-ring
K10D	Receiver Fixing Screw	AT8	Filling Port Lower O-Ring
P01D	Lower Picatinny	AT9	Filling Port Set-Screw
P02D	Picatinny Fixing Screw	AT10	Filling Port Spring
M3	Cocking Lever fixing Screw	AT11	Filling Port Valve
M4	Cocking Lever Fixing Nut	AT12	Filling Port Valve O-Ring
M5	Cocking Lever Combination Screw	AT13	Filling Port
M6	Cocking Lever Connecting Part	AT15	Valve Block O-rings
M7	Connecting Pin	AT16	Valve Block
M8	Needle	AT17	Long Valve
M9	Needle Connection Part	AT18	Long Valve Spring
M10	Hammer Spring	AT19D	Valve Block
M11	Cocking Lever	AT20D	Manometer
M12	Hammer setting screw	AT21	Manometer Lower O-Ring
M13D	Safety	AT26	500 cc Air Tube
M14	Hammer	AT40	Detachable Airtube Cover
M15	Needle Connection Part Spring	AT41	Detachable Airtube Cover O-Ring
M16	Needle Spring Set-Screw	AT42	Detachable Airtube Area
M17	Safety Set-Screw	AT43	Detachable Airtube Nut
M18	Safety Spring	AT44	Detachable Airtube Nut Screw
M19	Safety Ball	AT45	Detachable Airtube Nut Cover



KRAL ARMS

MECHANISM PARTS AND PART NUMBERS



NP-500



KRAL ARMS

MECHANISM PARTS AND
PART NUMBERS

NP-500

TK1	Butt Pad	M21	Adjustable Power Set-Screw
TK2	Butt Pad Fixing Part	M22	Adjustable Power Spring
TK3	Butt Pad Log Pin	M23	Adjustable Power Pin
TK4	Tactical Stock	M24	Barrel Fixing Set-Screw
TK5	Tactical Fixing Tube	M25	Adjustable Power O-Ring
TK6	Cheek Piece	M26	Adjustable Power Ball
TK7	Cheek Piece Button	M27	Adjustable Power Spring
TK8	Cheek Piece Log Pin	M28NP	Adjustable Power Button
TK9	Cheek Piece Button Spring	M29	Trigger Spring
TK10	Cheek Piece Stock Right	M30	Inner Hammer Spring
TK11	Cheek Piece Stock Left	M31	Locking Spring
TK12	Cheek Piece Stock Nuts	M32	Trigger
TK21	Lock Pin	M33	Inner Hammer
TK22	Lock Fixing Pin	M34	Loading Part
TK23	To and Fro Button Pin	M35	Inner Hammer Holder
TK24	To and Fro Button Spring	M36	Hammer Holder Cover
TK25	To and Fro Button Button	M37	Hammer Holder Adjustable Set-Screw
TK26	Tactical Stock Fixing Screw	M38	Trigger Group Fixing Pin
K10NP 500	Receiver Fixing Screw	M39	Trigger Wire
K12	Picatinny Assemble Nut	M40	Trigger
K13	Picatinny Assemble Screw	M41	Trigger Set-Screw
K21	NP-500 Stock	M48	Valve Block Fixing Set-Screw
K17	Dazzle Stock	M53	Hammer to Receiver Screw
TK26	Tactical and Folding Fixing Pin	BR1NP	Barrel Shroud
TK27	Tactical Stock Fixing Screw	BR3 NP	Shroud Centering Part
M45	Grip Screw	BR4	Shroud Centering Nut
M46	Grip	BR5NP	Barrel
M47	Grip Cover	BR6	Barrel Outer O-ring
K10D	Receiver Fixing Screw	BR7	Barrel Inner O-ring
P01D	Lower Picatinny	AT1	Tube Front Valve Block O-ring
P02D	Picatinny Fixing Screw	AT8	Filling Port Lower O-Ring
M3	Cocking Lever fixing Screw	AT9	Filling Port Set-Screw
M4	Cocking Lever Fixing Nut	AT10	Filling Port Spring
M5	Cocking Lever Combination Screw	AT11	Filling Port Valve
M6	Cocking Lever Connecting Part	AT12	Filling Port Valve O-Ring
M7	Connecting Pin	AT13NP	Filling Port
M8	Needle	AT15	Valve Block O-rings
M9	Needle Connection Part	AT16	Valve Block
M10	Hammer Spring	AT17	Long Valve
M11	Cocking Lever	AT18	Long Valve Spring
M12	Hammer setting screw	AT19NP	Valve Block
M13NP	Safety	AT20NP	Manometer
M14	Hammer	AT21	Manometer Lower O-Ring
M15	Needle Connection Part Spring	AT22	Safety FixinG Part
M16	Needle Spring Set-Screw	AT23	Safety Lower O-Ring
M17	Safety Set-Screw	AT24	Safety pulley
M18	Safety Spring	AT25	Connecting Block
M19	Safety Ball	AT26	500 CC Air Tube
M20NP	Receiver		



KRAL ARMS

MECHANISM PARTS AND PART NUMBERS

BIGHORN





KRAL ARMS

MECHANISM PARTS AND PART NUMBERS

BIGHORN

N01	Butt Pad Screw	M32	Trigger
N05	Receiver Fixing pulley	M33	Inner Hammer
K1	Butt Pad	M34	Loading Part
K2	Butt Pad Fixing Part	M35	Inner Hammer Holder
K3	Buttpad Fixing Body	M36	Hammer Holder Cover
K6	Butt Pad Button Spring	M37	Hammer Holder Adjustable Set-Screw
K7	Butt Pad Button	M38	Trigger Group Fixing Pin
KP8	Cheek Piece Fixing Set Screw Part	M39	Trigger Wire
KP9	Fixing Set Screw	M40	Trigger
K10BiG	Stock Fixing Screw	M41	Trigger Set-Screw
K12	Picatinny Assemble Nut	M48	Valve Block Fixing Set-Screw
K13	Picatinny Assemble Screw	M53	Hammer Fixing Part Screw
K23	Bighorn Stock	BR1BiG	Barrel Shroud
M3	Cocking Lever fixing Screw	BR2	Shroud Centering O-Ring
M4	Cocking Lever Fixing Nut	BR3	Shroud Centering Part
M5	Cocking Lever Combination Screw	BR4	Shroud Centering Nut
M6	Cocking Lever Connecting Part	BR5BiG	Barrel
M7	Connecting Pin	BR6	Barrel Outer O-Ring
M8	Needle	BR7	Barrel Inner O-Ring
M9	Needle Connection Part	AT1	Tube Front Valve Block O-ring
M10	Hammer Spring	AT8	Filling Port Lower O-Ring
M11	Cocking Lever	AT9	Filling Port Set-Screw
M12	Hammer setting screw	AT10	Filling Port Spring
M13BiG	Safety	AT11	Filling Port Valve
M14	Hammer	AT12	Filling Port Valve O-Ring
M15	Needle Connection Part Spring	AT13BiG	Filling Port
M16	Needle Spring Set-Screw	AT15	Valve Block O-Rings
M17	Safety Set-Screw	AT16	Valve Block
M18	Safety Spring	AT17	Long Valve
M19	Safety Ball	AT18	Long Valve Spring
M20BiG	Receiver	AT19BiG	Valve Block
M21	Adjustable Power Set-Screw	AT20BiG	Manometer
M22	Adjustable Power Spring	AT21	Manometer Lower O-Ring
M23	Adjustable Power Pin	AT22	Safety FixinG Part
M24	Barrel Fixing Set-Screw	AT23	Safety Lower O-Ring
M29	Trigger Spring	AT24	Safety Pulley
M30	Inner Hammer Spring	AT25	Connecting Block
M31	Locking Spring	AT26	500 cc Air Tube



KRAL ARMS

MECHANISM PARTS AND PART NUMBERS

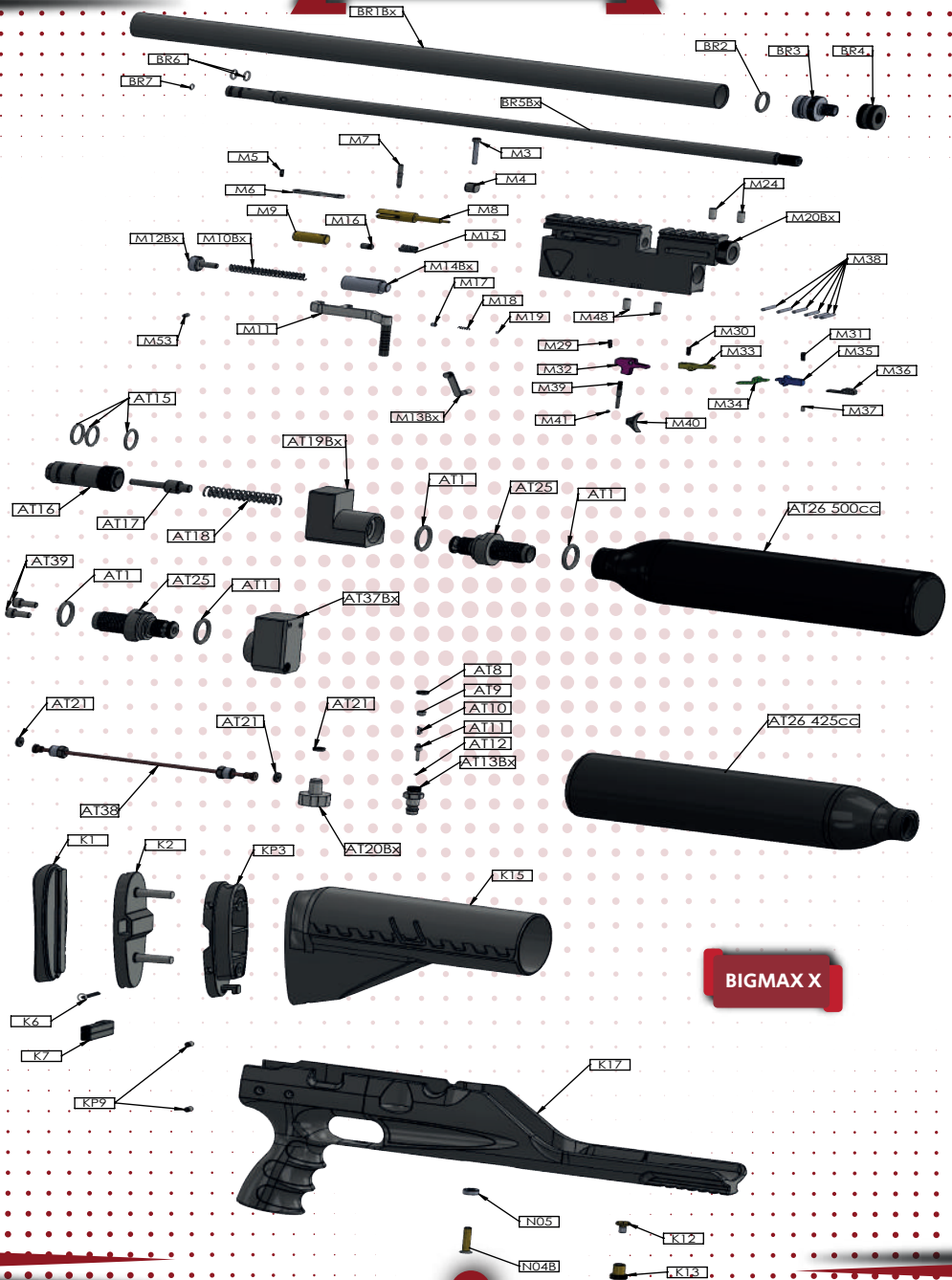

BIGMAX X



KRAL ARMS

MECHANISM PARTS AND PART NUMBERS

BIGMAX X

K1	Butt Pad	M33	Inner Hammer
K2	Butt Pad Fixing Part	M34	Loading Part
KP3	Butt Pad Fixing Body	M35	Inner Hammer Holder
K6	Butt Pad Button Spring	M36	Inner Hammer Cover
K7	Butt Pad Button	M37	Hammer Holder Adjustable Set-Screw
KP9	Fixing Set Screw	M38	Trigger Group Fixing Pin
K12	Picatinny Assemble Nut	M39	Trigger Wire
K13	Picatinny Assemble Screw	M40	Trigger
K15	Air Tube Cover	M41	Trigger Set-Screw
K17	Bigmax X Stock	M53	Hammer to Receiver Screw
N04Bx	Receiver Fixing Screw	BR1Bx	Barrel Shroud
N05	Receiver Fixing Pulley	BR2	Shroud Centering O-Ring
M3	Cocking Lever Fixing Screw	BR3	Shroud Centering Part
M4	Cocking Lever Fixing Nut	BR4	Shroud Centering Nut
M5	Cocking Lever Combination Screw	BR5Bx	Barrel
M6	Cocking Lever Connecting Part	BR6	Barrel Outer O-ring
M7	Connecting Pin	BR7	Barrel Inner O-ring
M8	Needle	AT1	Air Tank Front Valve Block O-ring
M9	Needle Connection Part	AT8	Filling Port Lower O-Ring
M10Bx	Hammer Spring	AT9	Filling Port Set-Screw
M11	Cocking Lever	AT10	Filling Port Spring
M12Bx	Hammer setting screw	AT11	Filling Port Valve
M13Bx	Safety	AT12	Filling Port Valve O-Ring
M14Bx	Hammer	AT13Bx	Filling Port
M15	Needle Connection Part Spring	AT16	Valve Block
M16	Needle Spring Set-Screw	AT17	Long Valve
M17	Safety Set-Screw	AT18	Long Valve Spring
M18	Safety Spring	AT19Bx	Airtube Block
M19	Safety Ball	AT20Bx	Manometer
M20Bx	Receiver	AT21	Manometer Lower O-Ring
M24	Barrel Fixing Set-Screw	AT25	Connecting Block
M29	Trigger Spring	AT26	425 Air Tube
M30	Inner Hammer Spring	AT26	500 cc Air Tube
M31	Locking Spring	AT37Bx	Air Tube Rear Block
M32	Trigger	AT38	Rear
		AT39	Rear Air Tube Fixing Screw



KRAL ARMS

MECHANISM PARTS AND
PART NUMBERS

PRO 500

N01	Butt Pad Screw	M34	Loading Part
N02	Butt Pad	M35	Inner Hammer Holder
K10PRO 500	Receiver Fixing Screw	M36	Hammer Holder Cover
K12	Picatinny Assemble Nut	M37	Hammer Holder Adjustment Set-Screw
K13	Picatinny Assemble Screw	M38	Trigger Group Fixing Pin
K22	PRO 500 Stock	M39	Trigger Wire
M3	Cocking Lever fixing Screw	M40	Trigger
M4	Cocking Lever Fixing Nut	M41	Trigger Set-Screw
M5	Cocking Lever Combination Screw	M48	Valve Block Fixing Set-Screw
M6	Cocking Lever Connecting Part	M53	Hammer to Receiver Screw
M7	Connecting Pin	BR1PRO 500	Barrel Shroud
M8	Needle	BR2	Shroud Centering O-Ring
M9	Needle Connection Part	BR3	Shroud Centering Part
M10	Hammer Spring	BR4	Shroud Centering Nut
M11	Cocking Lever	BR5PRO 500	Barrel
M12	Hammer setting screw	BR6	Barrel Outer O-ring
M13PRO 500	Safety	BR7	Barrel Inner O-ring
M14	Hammer	AT1	Tube Front Valve Block O-ring
M15	Needle Connection Part Spring	AT8	Filling Port Lower O-Ring
M16	Needle Spring Set-Screw	AT9	Filling Port Set-Screw
M17	Safety Set-Screw	AT10	Filling Port Spring
M18	Safety Spring	AT11	Filling Port Valve
M19	Safety Ball	AT12	Filling Port Valve O-Ring
M20PRO 500	Receiver	AT13PRO 500	Filling Port
M21	Adjustable Power Set-Screw	AT15	Valve Block O-rings
M22	Adjustable Power Spring	AT16	Valve Block
M23	Adjustable Power Pin	AT17	Long Valve
M24	Barrel Fixing Set-Screw	AT18	Long Valve Spring
M25	Adjustable Power O-Ring	AT19PRO 500	Valve Block
M26	Adjustable Power Ball	AT20PRO 500	Manometer
M27	Adjustable Power Spring	AT21	Manometer Lower O-Ring
M28D	Adjustable Power Button	AT22	Safety Fixing Part
M29	Trigger Spring	AT23	Safety Lower O-Ring
M30	Inner Hammer Spring	AT24	Safety pulley
M31	Locking Spring	AT25	Connecting Block
M32	Trigger	AT26	500 CC Air Tube
M33	Inner Hammer		



KRAL ARMS

MECHANISM PARTS AND PART NUMBERS

SHADOW

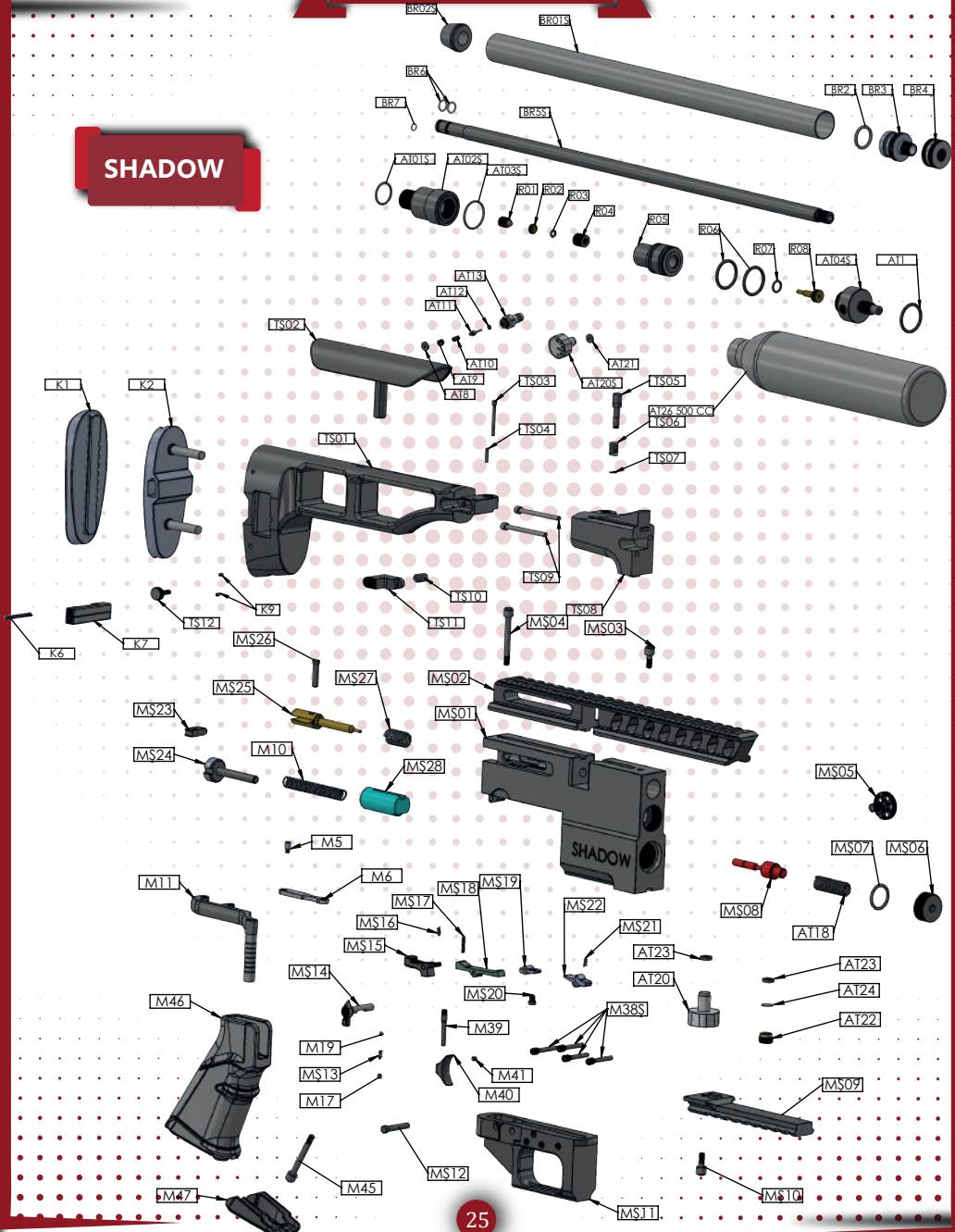



KRAL ARMS

MECHANISM PARTS AND PART NUMBERS

SHADOW

K1	Butt Pad	M\$20	Trigger Setting Set-Screw
K2	Butt Pad Fixing Part	M\$21	Inner Hammer Holder Spring
K6	Butt Pad Button Spring	M\$22	Inner Hammer Holder
K7	Butt Pad Button	M\$23	Cocking Lever Nut
K9	Stock fixing set-screw	M\$24	Hammer setting screw
T\$01	Tactical Stock	M\$25	Needle
T\$02	Cheek Piece	M\$26	Connecting Pin
T\$03	Button Fixing Long Pin	M\$27	Needle Spring
T\$04	Button Fixing Short Pin	M\$28	Hammer
T\$05	Folding Stock Pin	M38\$	Trigger Group Pins
T\$06	Folding Stock Pin Spring	AT18	Valve Spring
T\$07	Folding Stock Connecting Pin	AT20	Manometer
T\$08	Folding Stock	AT22	Safety Part
T\$09	Folding Stock fixing screws	AT23	Safety O-ring
T\$10	Button Spring	AT24	Burst Disc
T\$11	Button	BR02	Shroud Centering O-Ring
T\$12	Cheek Piece Setting Screw	BR03	Shroud Centering Cap
M5	Cocking Lever Connecting Part Screw	BR04	Shroud Centering Nut
M6	Cocking Lever Connecting Part	BR6	Barrel Outer O-ring
M10	Hammer spring	BR7	Barrel Inner O-ring
M11	Cocking Lever	B01\$	Barrel Shroud
M17	Safety Set-Screw	B02\$	Shroud Fixing Part
M19	Safety ball	BR5\$	Barrel
M39	Trigger Wire	AT1	Air Tank Front Valve Block O-ring
M40	Trigger	AT8	Filling Port Lower O-Ring
M41	Trigger Set-Screw	AT9	Filling Port Set-Screw
M45	Grip Screw	AT10	Filling Port Spring
M46	Grip	AT11	Filling Port Valve
M47	Grip Cover	AT12	Filling Port Valve O-ring
M\$01	Receiver	AT13	Filling Port
M\$02	Upper Picatinny	AT21	Manometer Lower O-ring
M\$03	Upper Picatinny Fixing Screw	AT26	500 cc Air Tube
M\$04	Cocking Lever Fixing Screw	AT01\$	Regulator Space front O-ring
M\$05	Barrel fixing wheel	AT02\$	Regulator Body
M\$06	Valve Cover	AT03\$	Regulator Body Rear O-ring
M\$07	Valve Cover O-Ring	AT04\$	Air Tube Front Block
M\$08	Valve	AT20\$	Manometer
M\$09	Lower Picatinny	R01	Regulator Adjustment Part
M\$10	Lower Picatinny Fixing Screw	R02	Regulator Pulley Adjustment Part
M\$11	Trigger box	R03	Regulator Pulley Adjustment Part O-ring
M\$12	Trigger box fixing pin	R04	Regulator Pulley
M\$13	Safety Spring	R05	Regulator
M\$14	Safety	R06	Regulator O-ring
M\$15	Trigger	R07	Pulley Fixing Part O-ring
M\$16	Trigger spring	R08	Pulley Fixing Part
M\$17	Inner Hammer Spring	P12K	Trigger Nut Screw
M\$18	Inner Hammer	P13K	Trigger
M\$19	Trigger Setting Part	P14K	Casting Trigger



KRAL ARMS

MECHANISM PARTS AND PART NUMBERS

NP-02

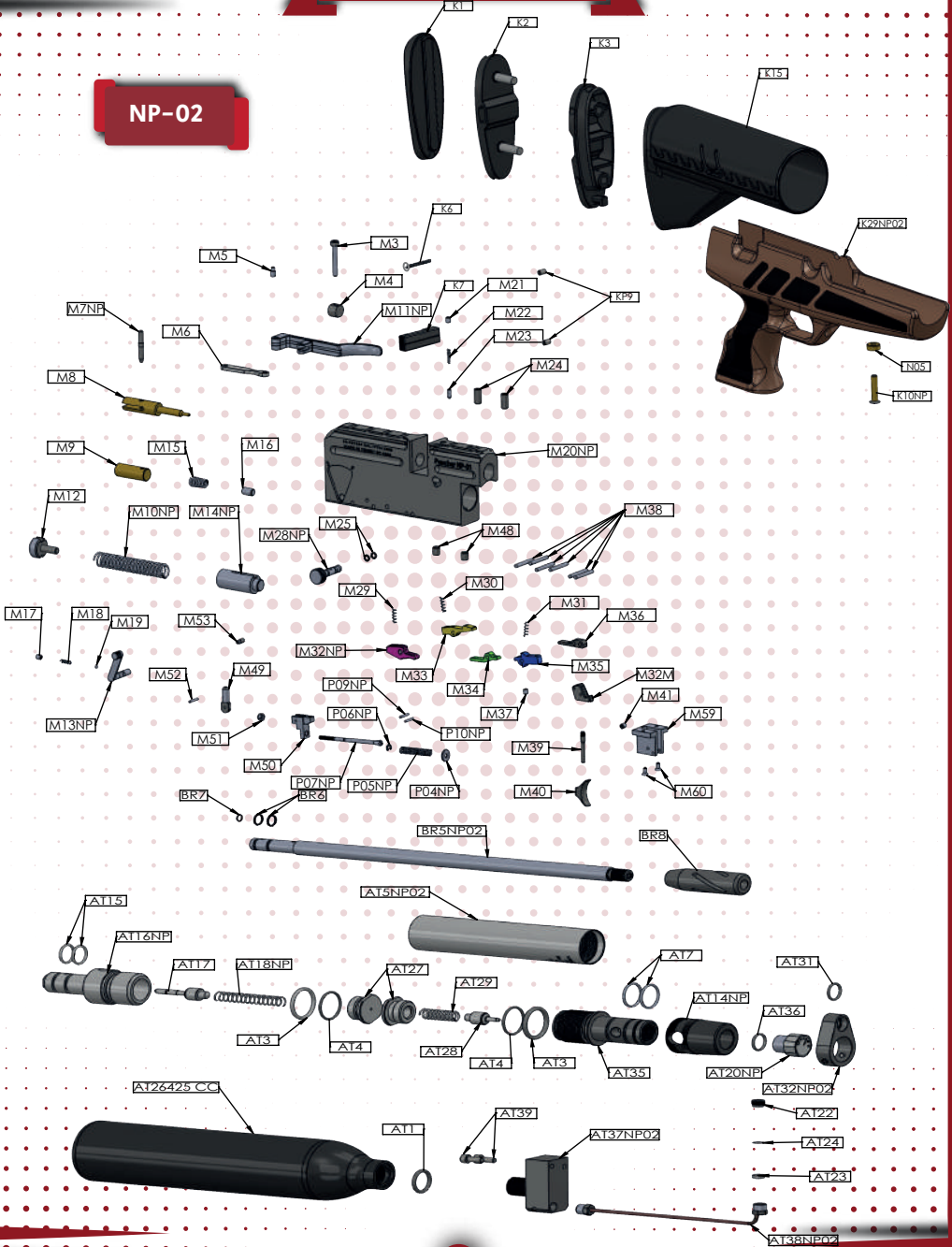



KRAL ARMS

MECHANISM PARTS AND PART NUMBERS

NP-02

K1	Butt Pad	M51	Trigger Wire Nut
K2	Butt Pad Fixing Part	M52	Trigger Loading Part Pin
K3	Butt Pad Log Pin	M53	Hammer to Receiver Screw
K6	Butt Pad Button Spring	M59	Trigger box
K7	Butt Pad Button	M60	Trigger Box Fixing Screw
KP9	Log Set-Screw	P04NP	Pulley
K10NP	Receiver Fixing Screw	P05NP	Trigger Spring
K15	Cheek Piece Log Pin Screws	P06NP	Folding Stock Connecting Pin
K29NP02	Stock	P07NP	Trigger Wire
N05	Pulley	P09NP	Short Pin
M3	Cocking Lever fixing Screw	P10NP	Long Pin
M4	Cocking Lever Fixing Nut	BR5NP02	Barrel
M5	Lock Pin	BR6	Barrel Outer O-ring
M6	Cocking Lever Connecting Part	BR7	Barrel Inner O-ring
M7NP	Connecting Pin	BR8	High Lighter
M8	To and Fro Button Button	AT1	Air Tank Front Valve Block O-ring
M9	Needle	AT3	Air Tank Front Valve Block O-ring(1)
M10NP	Hammer Spring	AT4	Air Tank Front Valve Block O-ring(2)
M11NP	Cocking Lever	AT5NP02	Air Tank Pipe
M12	Hammer setting screw	AT7	Filling Port Valve Block O-ring
M13NP	Safety	AT14NP	Filling Port Block Cover
M14NP	Hammer	AT15	Filling Port Block O-rings
M15	Needle Connection Part Spring	AT16NP	Valve Block
M16	Needle Spring Set-Screw	AT17	Long Valve
M17	Safety Set-Screw	AT18NP	Long Valve Spring
M18	Safety Spring	AT20NP	Manometer
M19	Safety Ball	AT22	Safety FixinG Part
M20NP	Receiver	AT23	Safety Lower O-Ring
M21	Adjustable Power Set-Screw	AT24	Safety pulley
M22	Adjustable Power Spring	AT26	425 CC Air Tube
M23	Adjustable Power Pin	AT27	Valve Block Cover
M24	Barrel Fixing Set-Screw	AT28	Short Valve
M25	Adjustable Power O-Ring	AT29	Short Valve Spring
M28NP	Adjustable Power Button	AT31	Filling Port Block Valve
M29	Trigger Spring	AT32NP02	NP-02 Ring
M30	Inner Hammer Spring	AT35	Filling Port Valve Block Valve
M31	Locking Spring	AT37NP02	Rear Block
M32NP	Trigger	AT38NP02	Rear
M33	Inner Hammer	AT39	Rear Block Fixing Screw
M34	Loading Part	AT17	Long Valve
M35	Inner Hammer Holder	AT18NP	Long Valve Spring
M36	Hammer Holder Cover	AT20	Manometer
M37	Hammer Holder Adjustable Set-Screw	AT21	Manometer Lower O-Ring
M38	Trigger Group Fixing Pin	AT22	Safety FixinG Part
M39	Trigger Wire	AT23	Safety Lower O-Ring
M40	Trigger	AT24	Safety pulley
M41	Trigger Set-Screw	AT27	Valve Block Cover
M48	Valve Block Fixing Set-Screw	AT28	Short Valve
M49	Loading Part Screw	AT29	Short Valve Spring
M50	Trigger Loading Part	AT30NP	Filling Port Block Valve



KRAL ARMS

MECHANISM PARTS AND PART NUMBERS

SUPER DUTY

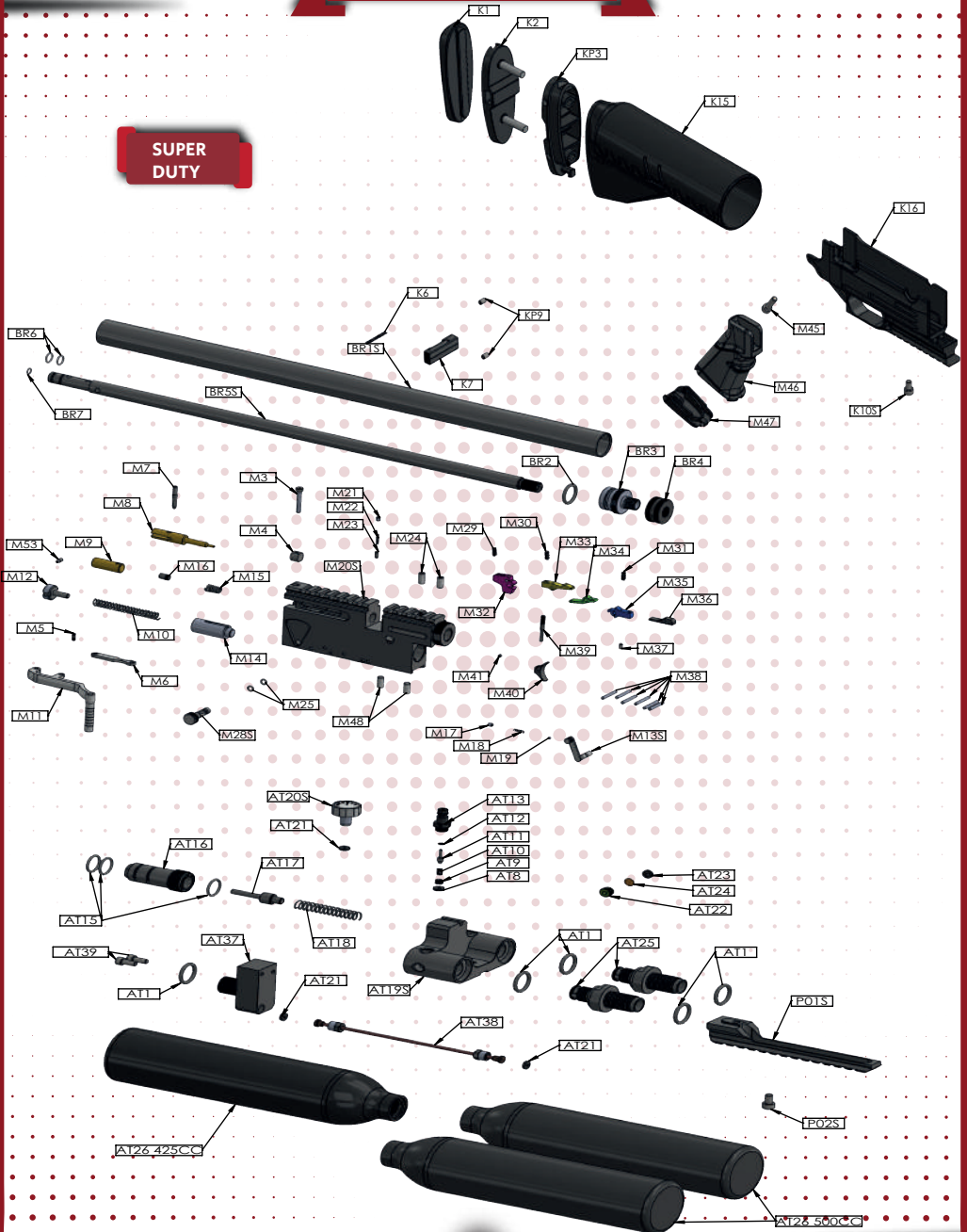



KRAL ARMS

MECHANISM PARTS AND PART NUMBERS

SUPER DUTY

K1	Butt Pad Screw	M33	Inner Hammer
K2	Butt Pad Fixing Part	M34	Loading Part
KP3	Butt Pad Fixing Body	M35	Inner Hammer Holder
K6	Butt Pad Button Spring	M36	Inner Hammer Cover
K7	Butt Pad Button	M37	Hammer Holder Adjustable Set-Screw
KP9	Fixing Set Screw	M38	Trigger Group Fixing Pins
K10S	Receiver Fixing Screw	M39	Trigger Wire
K15	Air Tube Cover	M40	Trigger
K16	Super Duty Receiver	M41	Trigger Set-Screw
M45	Grip Screw	M53	Hammer to Receiver Screw
M46	Grip	BR1S	Barrel Shroud
M47	Grip Cover	BR2	Shroud Centering O-Ring
M3	Cocking Lever Fixing Screw	BR3	Shroud Centering Part
M4	Cocking Lever Fixing Nut	BR4	Shroud Centering Nut
M5	Cocking Lever Combination Screw	BR5S	Barrel
M6	Cocking Lever Connecting Part	BR6	Barrel Outer O-ring
M7	Connecting Pin	BR7	Barrel Inner O-ring
M8	Needle	AT1	Air Tank Front Valve Block O-ring
M9	Needle Connection Part	AT8	Filling Port Lower O-Ring
M10	Hammer Spring	AT9	Filling Port Set-Screw
M11	Cocking Lever	AT10	Filling Port Spring
M12	Hammer setting screw	AT11	Filling Port Valve
M13S	Safety	AT12	Filling Port Valve O-Ring
M14	Hammer	AT13	Filling Port
M15	Needle Connection Part Spring	AT16	Valve Block
M16	Needle Spring Set-Screw	AT17	Long Valve
M17	Safety Set-Screw	AT18	Long Valve Spring
M18	Safety Spring	AT19S	Air Tube Block Body
M19	Safety Ball	AT20S	Manometer
M20S	Receiver	AT21	Manometer Lower O-Ring
M21	Adjustable Power Set-Screw	AT22	Safety FixinG Part
M22	Adjustable Power Spring	AT23	Safety Lower O-Ring
M23	Adjustable Power Pin	AT24	Safety Pully
M24	Barrel Fixing Set-Screw	AT25	Connecting Block
M25	Adjustable Power O-Ring	AT26	425 cc Air Tube
M28S	Adjustable Power Button	AT26	500 cc Air Tube
M29	Trigger Spring	AT37	Air Tank Rear Block
M30	Inner Hammer Spring	AT38	Rear
M31	Locking Spring	AT39	Rear Air Tube Fixing Screw
M32	Trigger	P01S	Lower Picatinny
		P02S	Lower Picatinny Fixing Screw



KRAL ARMS

PRODUCT

Type : _____
Brand : _____
Model : _____
Serial : _____
Caliber : _____
Barrel Length : _____

WARRANTY CERTIFICATE



KRAL ARMS

CUSTOMER

Name : _____
Surname : _____
Address : _____
Tel : _____
ID : _____

SELLING COMPANY

Title : _____
Address : _____
Tel : _____
Invoice Date : _____
Invoice Number : _____
Signature : _____

Delivery Date and Location : _____

Maximum Date Time : 20 Days

Warranty Period : 2 Years

Producer / Importer Company

KRAL ARMS

Tel: 0332 524 68 70 Px : 0332 524 68 71

www.kralarms.com

P.K. 42720 - Beyşehir/KONYA



KRAL ARMS



+90332 524 68 70



+90332 524 68 71



export@kralarms.com



www.kralarms.com



42720 - Beyşehir / KONYA

